

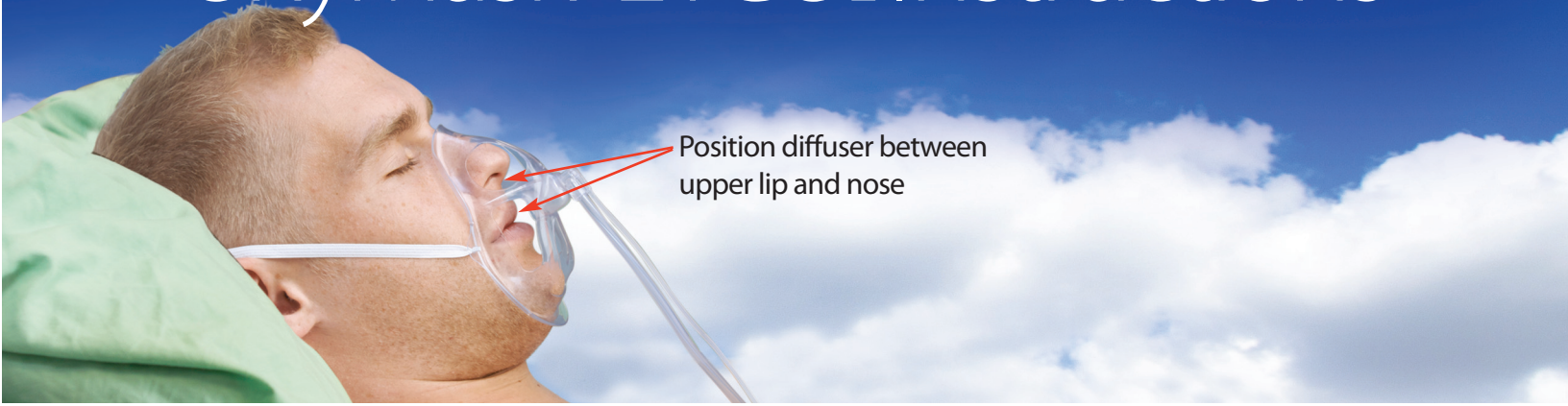

# OxyMask™ ETCO<sub>2</sub> Instructions



Proper positioning and fit of the OxyMask™ ETCO<sub>2</sub> is important.

An appropriately sized OxyMask™ ETCO<sub>2</sub> will fit below the eyes and cup the underside of the chin. **Center** the pin and diffuser between the nose and upper lip area.

- 1 **Remove the mask from the packaging, recycle or discard the plastic insert.**
- 2 Place the mask on the patient's face and position elastic strap at a comfortable tension below the ears or at the crown of the head. Adjust the tubing at the swivel to relieve any twisting.
- 3 Attach the universal connector at the end of the mask tubing to an oxygen source, then attach the ETCO<sub>2</sub> sample line to a side stream CO<sub>2</sub> monitor, to obtain tracings.
- 4 **Adjust the oxygen flow from 1 to 15 lpm to achieve prescribed patient oxygen saturation or oxygen flow rate.**
- 5 Allow patient to stabilize on oxygen flow and assess. Adjust the oxygen flow rate as necessary to achieve or maintain prescribed oxygen saturation.

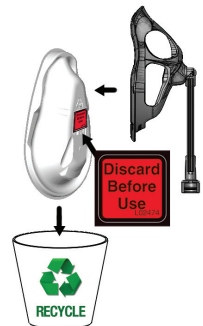

OxyMask™ ETCO<sub>2</sub> Adult

OxyMask™ ETCO<sub>2</sub> Plus  
25% Larger

OxyMask™ ETCO<sub>2</sub> Kid  
3-10 years old  
33-70 lbs (15-32 kgs)



Female connector available on 8" sampling pigtails



Male connector available on sampling lines (codes with SLM)

#### OxyMask™ ETCO<sub>2</sub> Flow Rates

Actual FiO<sub>2</sub> will vary. Breath rate, depth of breathing and distance of the diffuser from the face will affect performance. Actual flow rate required should be prescribed in conjunction with the use of a pulse oximeter.

Oxygen Flow Settings	Approx. O <sub>2</sub> Concentrations
1 LPM	24% - 25%
2 LPM	27% - 32%
4 LPM	34% - 40%
6 LPM	42% - 48%
8 LPM	49% - 55%
10 LPM	53% - 58%
12-15 LPM	59% - 65%

