



# OxyMask™ Instructions



Position diffuser between upper lip and nose

## Proper positioning and fit of the OxyMask™ is important.

An appropriately sized OxyMask™ will fit below the eyes and cup the underside of the chin.

**Center** the pin and diffuser between the nose and above the upper lip area.

**1 Remove the mask from the packaging, recycle or discard the plastic insert.**

- Place the mask on the patient's face and position elastic strap at a comfortable tension below the ears or at the crown of the head. Adjust tubing at swivel to relieve any twisting.
- Attach the tubings universal connector to an oxygen source.
- Adjust the oxygen flow from 1 to 15+ lpm to achieve prescribed patient oxygen saturation or oxygen flow rate.
- Allow patient to stabilize on oxygen flow and assess. Adjust oxygen flow rate as necessary to achieve or maintain prescribed oxygen saturation.

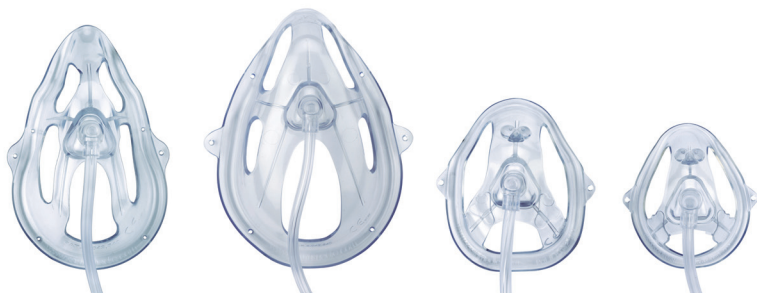
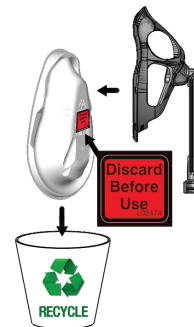

OxyMask™ Adult

OxyMask™ Plus  
25% Larger

OxyMask™ Kid  
3-10 years old  
33-70 lbs (15-32 kgs)

OxyMask™ Tyke  
6 months - 3 years old  
16-33 lbs (7-15 kgs)

**OxyMask™ Adult, Plus and Kid Flow Rates**

Actual FiO<sub>2</sub> will vary. Breath rate, depth of breathing and distance of the diffuser from the face will affect performance. Actual flow rate required should be prescribed in conjunction with the use of a pulse oximeter.

Flowrate	FiO <sub>2</sub>
1 LPM	24% - 27%
2 LPM	27% - 32%
3 LPM	30% - 60%
4 LPM	33% - 65%
5 LPM	36% - 69%
7 LPM	43% - 80%
10 LPM	53% - 85%
12 LPM	57% - 89%
≥15LPM	60% - 90%

**OxyMask™ Tyke Flow Rates**

Adjust flow from .25 L/min up to required flow to achieve required oxygen level using a pulse oximeter.

Flowrate	FiO <sub>2</sub>
.25 LPM	22%
.50 LPM	25%
.75 LPM	30%
1 LPM	35%
1.5 LPM	43%
2 LPM	47%
3 LPM	50%
≥5 LPM	65%

